

Licensees Compliance Assessment Report - Aggregate Resources Act

Background Information

Year: 2014

Licensee: **St. Marys Cement Inc. (Canada)**

Licence ID #: **624984 Codrington Pit**

MNR District/Area Office: **Peterborough**

Lot: **Pt. Lots 32-34**

Conc.: **6**

Geographic Twp.: **Murray**

Municipality: **Mun. of Brighton**

Observations

OPERATING STANDARDS	IN COMPLIANCE?			COMMENTS	Remedial Action?
	Yes	No	N/A		
A - Site Access					Y
A1 Boundaries (clearly marked)	✓			Fencing in progress at West Parcel – post installation ongoing at north and west boundary. East and south boundary to be demarcated when fence installed (fence to be offset from boundary). Wood stakes at corners of East Parcel – boundary to be fenced prior to extractive operations.	
A2 Entrance and Exits (location/closed)	✓			Off-site entrance for aggregate haulage at County Road 30 is gated. Farm access at Conc. 5 & 6 Road Allowance is also gated. Two entrances for site preparation purposes at north boundary of West Parcel. Western access is temporary and will be discontinued when necessary. Eastern access is to be the permanent entrance to the West Parcel for aggregate haulage and will be gated prior to haulage operations. Gates to be installed at access between West and East Parcels when established. No activity at East Parcel at this time.	
A3 Lease/Ownership/Extraction Agreement				Ownership	
B - Site Protection					
B4 Fencing	✓			See A1. Fencing at south and east boundary of West Parcel to be off-set from boundary to interior of pit except where fence will connect with proposed gate at point of access between West and East Parcel.	
B5 Fencing (site plan variation or temporary relief granted)	✓			Fencing of West Parcel to occur in stages within 1 to 2 years of licence issuance. Fencing of East Parcel to occur prior to extractive operations.	
B6 Screening (trees/berms)	✓			Berm constructed at southwest corner of West Parcel as required prior to extraction in Phase 1. Final shaping and hydroseeding of berm to be completed.	
B7 Setbacks (15m / 30m or other)	✓			Setbacks are in place.	
C - Operational Details					
C8 Operating Sequence	✓			Minor excavation in Phase 1, West Parcel, for internal roads / processing area.	
C9 Stripping (overburden)	✓			Overburden stripped from two agricultural fields in Phase 1 used for berm construction at southwest corner of West Parcel.	
C10 Overburden Seeded	✓			Overburden placed in berm which is to be hydro-seeded.	
C11 Extraction Depth	✓			Extraction (at max. depth) is permitted to +/- 155 m (asl). Lowest floor elevation +/- 189 m	
C12 Buildings/Scales (location)	✓			None are proposed. Scales and associated buildings are off-site at Road 30.	
C13 Equipment (any specific conditions or restrictions)	✓			One shovel (used in site preparation activities).	
C14 Plant (location/any specific conditions or restrictions)	✓			No plant on-site at this time.	
C15 Scrap (location/removal)		✓		Two piles of pre-licence (historic) scrap not in designated 'scrap area'.	Y
C16 Stockpiles (location)	✓			Minimal / minor stockpiles in extraction area at Phase 1.	
C17 Topsoil (location/seeded)	✓			Topsoil stripped from agricultural fields used in berm. Phase 1 wooded area topsoil to be used for reforestation as a part of early restoration effort (see D34).	
C18 Excavation Faces	✓			Minimal pit faces at this time (1 to 2 m in height) as per C8.	
C19 Ponds (location/depth)			✓	Seasonal natural pond in non-extraction area at West Parcel.	
C20 Internal Roads (any specific conditions or restrictions)	✓			Internal roads for site preparation and future haulage operations.	
C21 Haul Routes (external/any specific conditions or restrictions)	✓			Off-site aggregate haulage is to be via north boundary of West Parcel, across hydro easement and through licensee owned lands including adjacent Archer Pit to County Road 30. Off-site haul road construction is in progress.	
C22 Blast Monitoring Report (quarries only)			✓		
C23 Dust Suppression	✓			Suppressant to be used as necessary.	
C24 Hours of Operation (any specific conditions or restrictions)	✓			Site preparation activities are in accordance (Mon. to Fri. / 7 am to 7 pm).	
C25 Well Monitoring Reports	✓			Groundwater level monitoring / reporting is carried out.	
C26 Identification Sign (as per Sect. 5.22 of Provincial Standards)		✓		Signs have been ordered but are not installed. Signs required at: i) County Road 30 entrance ; ii) Main site (West Parcel) entrance ; iii) Ferguson Hill Road farm field access at Conc. 5 & 6 Road Allowance (West Parcel) ; iv) Access between East and West Parcel (when established).	Y
C27 Orderly Conditions	✓				
C28 Blasting Hours (quarries only)			✓		

Note: Any (✓ "No") requires completion of Page 3

Observations (continued)					
OPERATING STANDARDS	IN COMPLIANCE?			COMMENTS	Remedial Action?
	Yes	No	N/A		
D – Rehabilitation					Y
D29 Disturbed Hectarage	✓			Current year - # of hectares <u> ** </u> Total # of hectares <u> ** </u>	
D30 Progressive rehabilitation	✓			Current year - # of hectares <u> 0.0 </u> Total # of hectares <u> 0.0 </u>	
D31 Sloping of Faces	✓			Not required at this time.	
D32 Grades/Contours/Elevations	✓			Not required at this time.	
D33 Importation of Material (inert)	✓			No importation of fill for rehabilitation purposes.	
D34 Vegetation	✓			Former agricultural lands at the northwest part of the West Parcel (non-extraction area) are proposed to be re-vegetated in the Spring of 2015.	
D35 Final Rehabilitation	✓			Not required at this time.	
E - Prescribed Conditions (For Licences issued after June 27, 1997)					
E36 Other Monitoring Reports	✓			Noise Monitoring Program as per Environmental Noise Monitoring Program & Complaint Procedure (Aercoustics, Feb. 24/13): No monitoring required at this time. Monitoring to be undertaken within one (1) month of each time extraction moves into a new area, within each operational phase (as per ARA site plan).	
E37 Requirements of C of A's	✓			No processing equipment on-site at this time.	
E38 Noise Mitigation	✓			Noise mitigation berm has been constructed.	
E39 Fuel Storage Tanks	✓			No fuel storage on-site at this time.	
E40 Spills Plan	✓			Corporate plan is in effect.	
E41 Permit to Take Water	✓			Not required.	
E42 Dust Suppression Measures Req'd. (Haul routes, equip, etc.)	✓			Suppressants used as required.	
F - Other Conditions (As indicated on either Site Plan or Licence)					
F43 Tonnage Condition	✓			650, 000 tonnes per annum (including up to 50,000 tonnes of material that may be imported for blending purposes).	
F44 Community Liaison Group (CLG)				Public meeting held on April 10, 2014 in Codrington to organise CLG. Subsequent correspondence with interested community members has occurred. Site visit is planned for when site is accessible and in fuller operation.	
F45 Alternate 'back-up' warning devices				CBM has investigated alternative warning devices for use on CBM-owned equipment. Documentation of same to be provided to Municipality.	
F46 Complaint Response Procedure (Noise)				No noise complaints received to date. Documentation by CBM to include Noise Complaint Form as per Environmental Noise Monitoring Program & Complaint Procedure (Aercoustics, Feb. 24/13).	
F47 Natural Environment Report				<u>Installation of butternut tree protection fencing at south setback, West Parcel, by a qualified ecologist prior to berm construction: not required at this time.</u> Planting of conifer trees at edge of forested areas that are to be retained (i.e. in excavation setback or non-extraction area) is planned for the Spring of 2015.	
F48 Archaeological Assessment and Ministry of Tourism, Culture and Sport comments				<u>Buffer zone demarcation:</u> Archaeological sites are demarcated and have not been impacted by pit operations. <u>Markers at limit of extraction prior to extraction activities:</u> extraction limits adjacent to the archaeological sites will be demarcated prior to aggregate extraction occurring adjacent to the sites. <u>Worker training program:</u> instruction has been provided to workers.	
F49 Visual Impact Assessment				<u>Input from adjacent residents on berm construction:</u> Discussions have occurred with one homeowner and attempts made to contact the other homeowner. <u>Variations in berm height / slope / orientation subject to noise mitigation requirements:</u> Constructed berm has been built with a horizontal curve and final shaping will include rounding of berm. <u>Tree/shrub planting plan with input from adjacent residents:</u> Residents will be contacted prior to planting which is proposed for Spring of 2015.	
General Comments:					
ARA Licence dated January 30, 2014. On-site activity to date has consisted of: overburden stripping, berm construction, fencing, and minor extraction for internal road construction and processing plant set-up. Off-site activity has consisted of haul road construction from site to County Road 30.					
Licence ID#: 624984 Codrington Pit					

Note: Any (✓ "No") requires completion of Page 3

Date Submitted to MNR: Y / M / D	2014 / 09 / 23	Please ensure that the site plan you have is the most current, approved plan and is the same as the one MNR has on file.
Is the site held in reserve? <input type="checkbox"/> YES or <input checked="" type="checkbox"/> NO		

Copies of Report Sent to:	County/Regional Municipality	Local Municipality	Ministry of Natural Resources
(by September 30th)	<input checked="" type="checkbox"/> YES	<input checked="" type="checkbox"/> YES	<input checked="" type="checkbox"/> YES

TO BE COMPLETED BY PERSON CONDUCTING REVIEW (including on-site inspection)			
Date Inspected: Y / M / D	2014 / 9 / 9	Review Conducted by: (Please Print) Amarjit S. Sandhu	Signature (if different than licensee): 
Name of Company and Address: Pro - Inspect ; 10 Davey Crescent, Kingston, Ontario. K7N 1X6. Tel. 613-384-7067			
Position with Company: Principal			

Signature of Licensee or Authorized Official:  Mike Sebastian <i>Lands Manager</i>

FOR MNR OFFICE USE ONLY				
Accepted by MNR: (✓ one)	YES <input type="checkbox"/> NO <input type="checkbox"/>	Date Accepted: Y / M / D	/ /	MNR Signature:
Field Audit by MNR: (✓ one)	YES <input type="checkbox"/> NO <input type="checkbox"/>	Date Inspected: Y / M / D	/ /	MNR Signature:
Follow up Notice Required?	YES <input type="checkbox"/> NO <input type="checkbox"/>	Licence ID #:		

- Pursuant to Subsection 57(4) of the ARA, it is an offence to furnish false information.
- You must provide a sketch if remedial action is required or progressive rehabilitation has been performed.
- In order to extend the 90-day remedial action deadline date, you must obtain the Aggregate Inspector's approval (in writing) prior to filing the report with the Inspector or local MNR office.
- Please submit this report to the local Aggregate Inspector who administers your site, or the local MNR office.

(NOTE: ALL INFORMATION IN RESPECT OF THIS REPORT IS AVAILABLE FOR PUBLIC REVIEW)

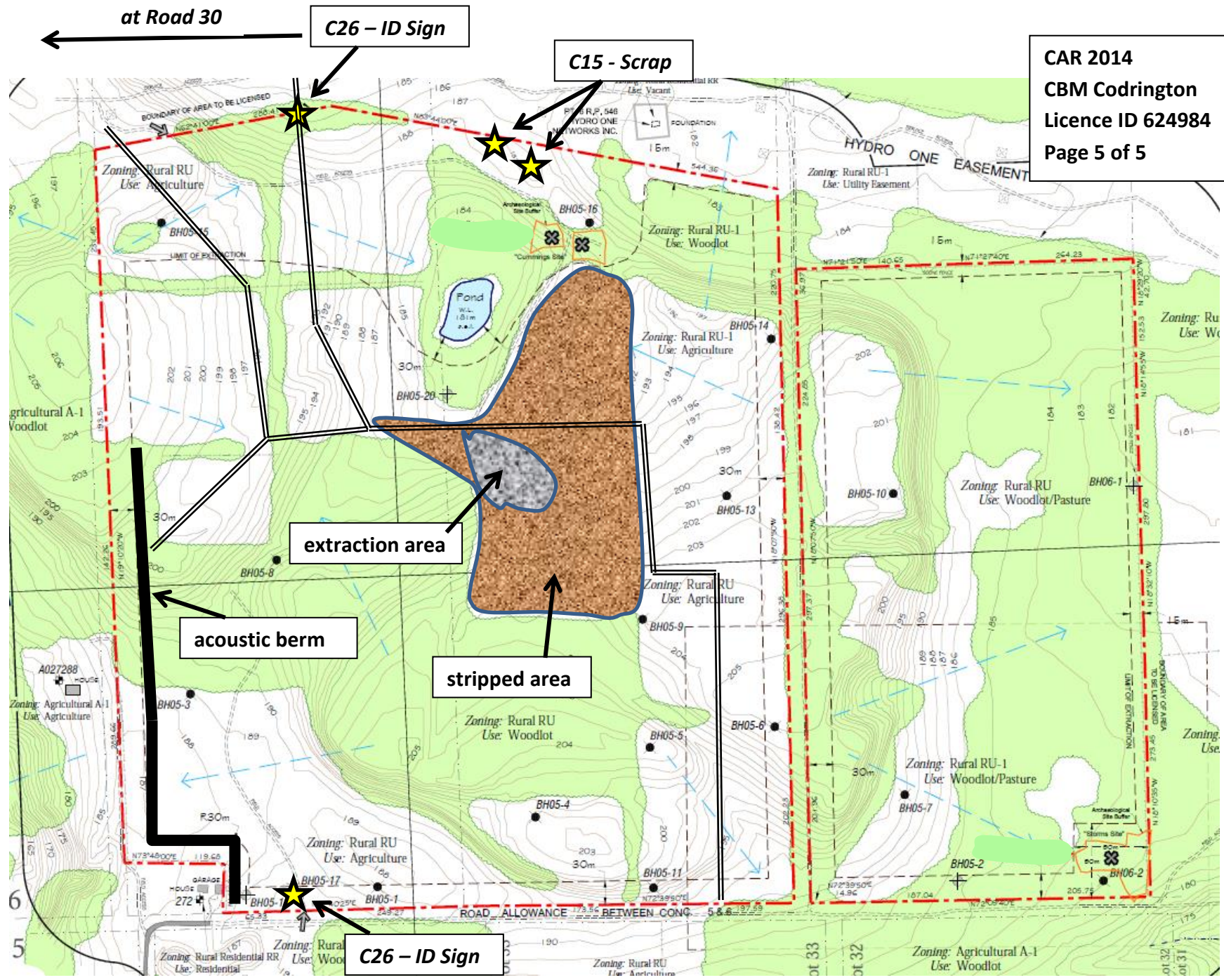

at Road 30

C26 - ID Sign

C15 - Scrap

extraction area

acoustic berm

stripped area

C26 - ID Sign